

## Medium Glasshouse – Specification

Approximate measurement: 13ft 3” x 8ft 11”

### Cedar

The framework is in a top grade Western Red Cedar which is grown on the Western Sea Board of North America. It has long been used in inclement climates in the construction and garden industries due to its longevity (the timber contains natural preservatives), stability (it does not easily warp or bend being straight grained) and strength. All of our cedar is sourced from certified or sustainable forests.

Cedar absorbs moisture readily which brings the natural preservatives to the surface, it does however give off absorbed moisture rapidly in its natural state, which causes no harm and is a natural process. There is a wide colour variation in the raw material, it mellows to a silver grey as exposed to weathering. Available in a choice of configurations including rustic shingles to compliment the country home.

### Glass

All our structures are glazed in Tempered Safety Glass to British Standard BS.6206

### Fixings

These are a combination of solid brass and stainless steel, both being suitable for use with Western Red Cedar due to their resistance to corrosion by the timber itself and extreme weather conditions.

### Aluminium

We use powder coated aluminium to provide improved weather protection, ventilation and long lasting strong rainwater goods.

The ogee gutters and downspouts are solid aluminium providing compatibility with proprietary rainwater systems and so may be used to link with rainwater saving tanks and butts.

The cedar roof spars are protected on the exterior by cappings with neoprene gaskets securing the glass and ensuring weatherproofing.

All glasshouses have an aluminium plinth on which the structures sit, this raises the timber off the brickwork protecting from rising moisture and giving a stronger fixing into the foundation.

The glasshouses have two aluminium roof vents automated by heat sensitive openers.

### Base

Upon confirmation of order we provide you with specification for the preparation of the base.

### Optional Extras

Sash windows over and above those offered as standard. Cedar staging and shelving - free standing or fixed. Should you prefer to substitute the cedar boarding with your own brickwork then we would provide a specification for the construction of the wall. Cedar shingles are available to replace the glass on the roof.

Medium Elevation

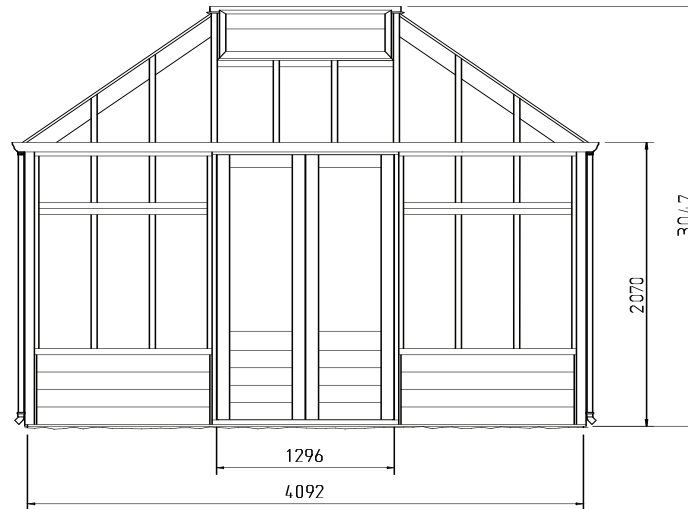

Medium Plan

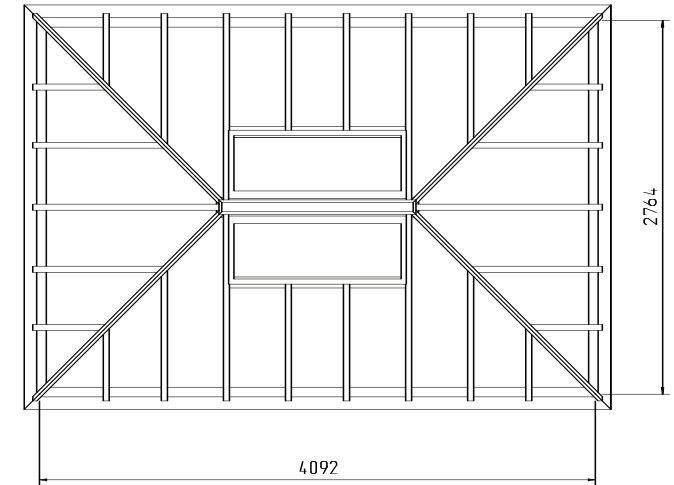

Base Dimensions: 2724 x 4052mm